

Crosby® Grab Hooks



H-330 / A-330



- Forged Steel - Quenched and Tempered.
- Design factor is 4:1.
- Features quick and easy assembly.
- H-330 designed for Crosby Spectrum 4® chain.
- A-330 designed for Crosby Spectrum 7® chain.

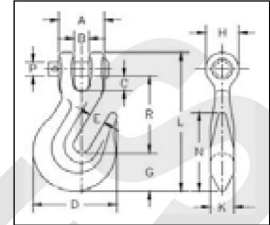

H-330 / A-330 Clevis Grab Hooks

Chain Size (in.)	Stock No.		Working Load Limit (lbs.)		Weight Each (lbs.)	Dimensions (in.)											
	H-330 Carbon	A-330 Alloy*	H-330 Carbon	A-330 Alloy		A	B	C	D	E	G	H	K	L	N	P	R
1/4	1027105	1027249*	2600	3500	.36	1.00	.32	.31	1.81	.34	.88	.72	.47	3.05	1.75	.31	1.64
5/16	1027123	1027267*	3900	4700	.62	1.22	.43	.36	2.12	.44	.97	.91	.59	3.66	2.06	.38	2.02
3/8	1027141	1027285*	5400	7100	1.00	1.42	.48	.49	2.53	.50	1.17	1.00	.72	4.42	2.34	.44	2.41
7/16	1027169	1027301	7200	8750	1.31	1.66	.66	.62	3.09	.56	1.31	1.13	.69	4.94	2.66	.56	2.75
1/2	1027187	1027329*	9200	12000	2.22	1.88	.57	.51	3.56	.66	1.53	1.25	.78	5.72	2.97	.63	3.19
5/8	1027203	1027347	13000	18100	4.41	2.31	.71	.67	4.39	.78	1.78	1.56	1.09	6.83	4.31	.75	4.09
3/4	1027221	1027365	20200	24700	6.50	2.62	.94	.94	5.22	.94	2.13	1.88	1.31	8.13	5.09	.88	4.63

* These A-330 hooks are forged with an "8" designating Grade 80, and are suitable for use with Grade 8 chain in over head lifting applications as long as hook is proof-tested as part of the chain sling assembly or as an individual component per ASME B30.9. We recommend the use of the A-338 which is proof tested and supplied with a proof test certificate.

H-323 / A-323



- Forged Steel - Quenched and Tempered.
- Design Factor is 4:1.
- H-323 designed for Crosby Spectrum 4® chain.
- A-323 designed for Crosby Spectrum 7® chain.

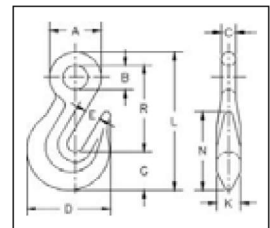

H-323 / A-323 Eye Grab Hooks

Chain Size (in.)	Stock No.		Working Load Limit (lbs.)		Weight Each (lbs.)	Dimensions (in.)											
	H-323 Carbon	A-323 Alloy*	H-323	A-323		A	B	C	D	E	G	K	L	N	R		
1/4	1026204	1026384*	2600	3500	.28	1.09	.53	.31	1.81	.34	.88	.47	3.05	1.75	1.88		
5/16	1026222	1026400*	3900	4700	.45	1.31	.62	.38	2.12	.44	.97	.59	3.59	2.06	2.28		
3/8	1026240	1026428*	5400	7100	.79	1.56	.75	.44	2.53	.50	1.17	.72	4.28	2.34	2.69		
1/2	1026286	1026464*	9200	12000	1.75	1.94	.88	.53	3.56	.66	1.53	.78	5.44	2.97	3.38		
5/8	1026302	1026482*	13000	18100	3.25	2.38	1.06	.66	4.41	.78	1.89	1.00	6.66	3.78	4.11		
3/4	1026320	1026507	20200	24700	5.94	2.88	1.38	.75	5.22	.94	2.13	1.31	8.06	5.09	5.16		

* These A-330 hooks are forged with an "8" designating Grade 80, and are suitable for use with Grade 8 chain in over head lifting applications as long as hook is proof-tested as part of the chain sling assembly or as an individual component per ASME B30.9. We recommend the use of the A-338 which is proof tested and supplied with a proof test certificate.

BL-GRB

Bullard Alloy Grab Hook with Latch

- Dimensions shown relate to H-323 / A-323 drawing scheme shown above.



Chain Size (in.)	BL-GRB Stock No.	Working Load Limit (lbs.)*	Weight Each (lbs.)	Dimensions (in.)											
				A	B	C	D	E	G	K	L	N	R		
1/4	1051904	3500	.50	1.25	.56	.28	2.47	.40	.86	.53	3.68	2.18	2.50		

* Ultimate Load is 4 times the Working Load Limit.